

Article	Range	A	B	C	Resolution	Accuracy	Code	Kg
IRIS 60 IT-T 28/52	28-52	60	8	8	0,01	0,01	00476	0,300
IRIS 60 IT-T 49/73	49-73	60	8	8	0,01	0,01	00497	0,300
IRIS 80 IT-T 30/54	30-54	80	10	9	0,01	0,01	00477	0,340
IRIS 80 IT-T 54/78	54-78	80	10	9	0,01	0,01	00498	0,340
IRIS 120 IT-T 30/54	30-54	120	12	9	0,01	0,01	00478	0,380
IRIS 120 IT-T 54/78	54-78	120	12	9	0,01	0,01	00499	0,380

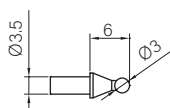

Article	Code
T	00517

TERMINALI A SFERA IN METALLO DURO PER CONTROLLO INGRANAGGI
IL RANGE È CONSIDERATO CON TERMINALE Ø3
DISPONIBILI TERMINALI DA Ø1,5 A Ø6

RODS WITH CARBIDE SPHERE FOR GEAR CONTROL
THE RANGE IS CONSIDERED WITH Ø3 RODS
AVAILABLE RODS FROM Ø1.5 TO Ø6



Article	Range	A	B	C	Resolution	Accuracy	Code	Kg
IRIS 60 IT-TS 40/64	40-64	60	8	8	0,01	0,01	00470	0,300
IRIS 60 IT-TS 61/85	61-85	60	8	8	0,01	0,01	00491	0,300
IRIS 80 IT-TS 42/66	42-66	80	10	9	0,01	0,01	00471	0,340
IRIS 80 IT-TS 66/90	66-90	80	10	9	0,01	0,01	00492	0,340
IRIS 120 IT-TS 42/66	42-66	120	12	9	0,01	0,01	00472	0,380
IRIS 120 IT-TS 66/90	66-90	120	12	9	0,01	0,01	00493	0,380

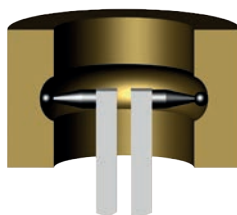
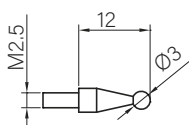
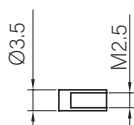

Article	Code	Article	Code
BAR60	02000	TS3	02030

RODS WITH SPHERE TSA Ø3 STANDARD EQUIPMENT
TERMINALI A SFERA TSA Ø3 IN DOTAZIONE STANDARD



INTERCHANGEABLE RODS OPTIONAL OPZIONE TERMINALI INTERCAMBIABILI

INTERCHANGEABLE RODS WITH SPHERE TERMINALI INTERCAMBIABILI CON SFERE CALIBRATE

Article	Ø	Code	Kg
TS 1	Ø 1	02010	0,005
TS 1,5	Ø 1,5	02015	0,005
TS 2	Ø 2	02020	0,005
TS 2,5	Ø 2,5	02025	0,005
TS 3	Ø 3	02030	0,005
TS 3,5	Ø 3,5	02035	0,005
TS 4	Ø 4	02040	0,005
TS 4,5	Ø 4,5	02045	0,005
TS 5	Ø 5	02050	0,005
TS 5,5	Ø 5,5	02055	0,005
TS 6	Ø 6	02060	0,005
TS 6,5	Ø 6,5	02065	0,005

INTERCHANGEABLE RODS OF WIDIA TERMINALI INTERCAMBIABILI CON SFERE IN WIDIA

Article	Ø	Code	Kg
TSW 1	Ø 1	02011	0,005
TSW 1,5	Ø 1,5	02016	0,008
TSW 2	Ø 2	02021	0,008
TSW 2,5	Ø 2,5	02026	0,008
TSW 3	Ø 3	02031	0,008
TSW 3,5	Ø 3,5	02036	0,008
TSW 4	Ø 4	02041	0,008
TSW 4,5	Ø 4,5	02046	0,008
TSW 5	Ø 5	02051	0,008
TSW 5,5	Ø 5,5	02056	0,008
TSW 6	Ø 6	02061	0,008
TSW 6,5	Ø 6,5	02066	0,008