

Pallet system racks PRS

Part No.: K551343

Weight 19.000 g

Rack for four pallets
For the loading receiver pallet system
328 mm x 646 mm x 780 mm
Made of aluminium, profiles

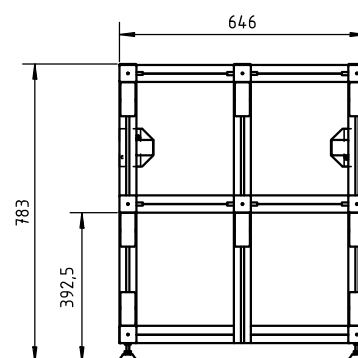

Part No.: K551342

Weight 19.000 g

Rack for two pallets
For the loading receiver pallet system
328 mm x 646 mm x 780 mm
Made of aluminium, profiles

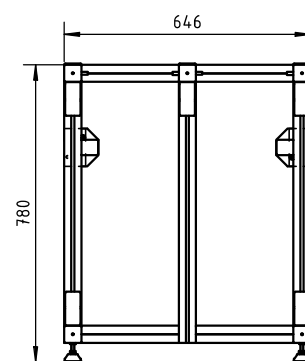

Part No.: K551345

Weight 3.815 g

Extension kit 2 – 4 pallets
For the loading receiver pallet system

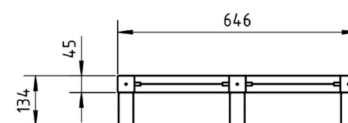

Part No.: K551346

Weight 1.460 g

Extension kit 4 – 6 pallets
For the loading receiver pallet system

